

Cable Cubby® Series

SURFACE-MOUNTABLE ENCLOSURE
FOR CABLES, AAPs, AND AC POWER

- Designed to mount discreetly into a table or flat surface
- Cables slide in and out for convenient access
- Accommodates Extron AAPs for hundreds of connectivity options
- One or two unswitched AC power outlets
- Lid slides down into enclosure (most models)
- Available in black anodized or brushed aluminum finish (most models)
- UL/CUL listed and CE compliant
- International models with UK, Australia, Central Europe, Switzerland, France, Israel, or India AC power outlets

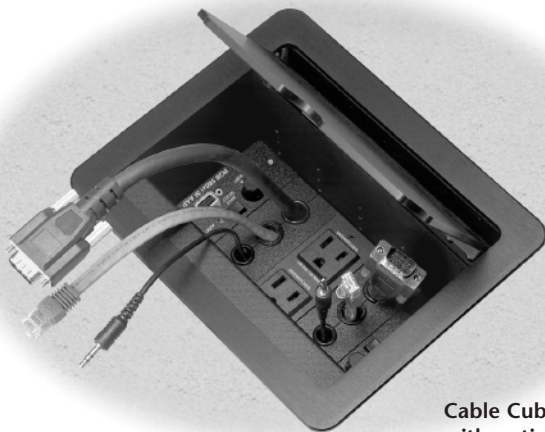

Cable Cubby 800 (Shown with optional RGB 580xi AAP and cables)

Cable Cubby enclosures offer convenient, table top storage management solutions for connectors and cables, storing them out of sight until needed.



Extron® Electronics

www.extron.com

DESCRIPTION

Extron **Cable Cubby**® enclosures provide inconspicuous access to A/V, power, data, and video connections, including Extron Architectural Adapter Plates (AAPs). With a variety of surface finishes available, the Cable Cubby is designed to mount discreetly into virtually any tabletop surface. The Cable Cubby enclosures fit nearly flush with the tabletop when closed and remain unobtrusive, even when in use.

Cutouts in the lid enable cables to be run in or out of the Cable Cubby's base with the lid closed. Most models are equipped with a square bezel with the exception of the Cable Cubby 300C which has a circular bezel, enabling it to be installed in three easy steps using a standard 6-inch hole saw.

Within its base, the Cable Cubby enclosure offers adjustable panels with three different sized holes to support a variety of cable diameters. On all models except the Cable Cubby 200, the adjustable panels can be raised or lowered to suit cable lengths and connector types. Any of the hundreds of Extron optional AAPs can be inserted adjacent to the panels. AAPs include passive and active pass-through connection points, as well as control modules.

Cable Cubby enclosures include one or two unswitched AC power outlets for additional power support (Australia, UK, France, Israel, India, and Central Europe models have one; USA and Switzerland, models have two).

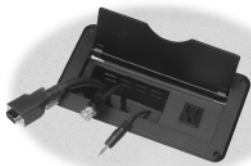

Cable Cubby 200

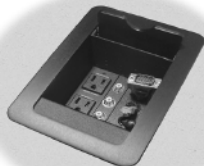

Cable Cubby 300S

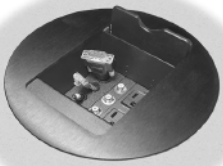

Cable Cubby 300C



Cable Cubby 600

FEATURES

- Low profile design with sliding door that can be stored out of sight when in use (Cable Cubby 300, Cable Cubby 600, and Cable Cubby 800 only)
- One or two unswitched AC power outlets
- Hundreds of AAP options for active or pass-through connectivity
- Available in black anodized or brushed aluminum finish* (Cable Cubby 300, Cable Cubby 600, and Cable Cubby 800 only)
- UL/CUL listed and CE compliant for worry-free integration, system inspections, and product safety
- Circular models can be easily installed using a standard 6 inch hole saw
- International models include UK, Australia, Central Europe, Switzerland, France, Israel, or India AC power outlets.

*Polished aluminum finish and brushed brass finish are also available. These models are built to order and require a longer lead time. Contact an Extron Customer Support Representative for more information.

NOTE: Cables and Architectural Adapter Plates (AAPs) are shown in the photos and diagrams above as examples only. Cables and AAPs are optional accessories for the Cable Cubby products and must be ordered separately.

INSTALLATION

Cable Cubby 300C

Preparation of the table surface is simple. For installation of the Cable Cubby 300C, a standard 6-inch hole saw is used to easily make the necessary cut into the tabletop. The installation is done in three easy steps:

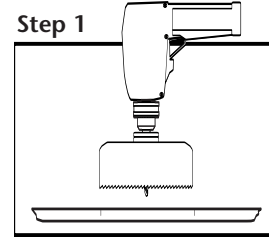

Use standard 6 inch hole saw to cut into table surface.

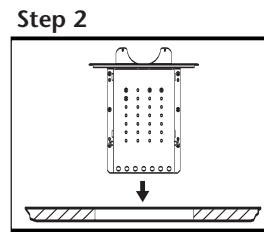

Place the Cable Cubby 300C into the cutout.

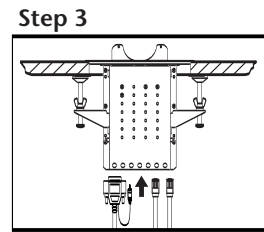

Make all connections and securely fasten Cable Cubby 300C onto table surface.

Cable Cubby 200, 300S, 600S, and 800S

For Cable Cubby models with a square bezel, Extron provides a routing guide free of charge for worry-free installation. Routing guides can be obtained from your Extron Customer Support Representative. Templates and cut-out dimensions can be downloaded from the Extron Web site (www.extron.com). An Extron streaming video I-Demo is available on the Web site that will walk you through the installation process step-by-step, from site preparation to troubleshooting. (<http://www.extron.com/download/idemo.asp>)

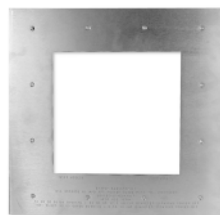

Cable Cubby 300S Router Template



GENERAL	
Rack mount	No, but furniture mountable
Enclosure type	Metal
NOTE: Architectural Adapter Plates (AAPs) are shown in the diagrams above and in photographs as examples only. AAPs are optional accessories for the Cable Cubby products. AAPs and cables must be ordered separately.	
Enclosure dimensions	
CAUTION: Use the appropriate metal Extron routing template or refer to the surface cutout dimensions here before cutting a hole in the furniture or other surface. Pay special attention to the direction the unit will face; the unit's AAP and connector access side is <u>underlined</u> . Extron is not responsible for miscut mounting holes.	
Cable Cubby 200	
Top plate (outer rim)	<u>8.000"</u> W x 4.394" D (20.32 cm W x 11.16 cm D)
Surface cutout (inside rim).....	<u>7.185 ±0.0325"</u> W x 3.155 ±0.0325" D (<u>18.25 ±0.083</u> cm W x 8.01 ±0.083 cm D)
Box (under surface)	4.000" H x <u>7.120"</u> W (front/rear of unit) x 2.974" D (10.16 cm H x <u>18.08</u> cm W x 7.55 cm D)
Cable Cubby 300S	
Top plate (outer rim)	<u>5.130"</u> W x 6.470" D (13.0 cm W x 16.4 cm D)
Surface cutout (inside rim)	<u>4.625 ±0.0325"</u> W x 5.970 ±0.0325" D (<u>11.75 ±0.083</u> cm W x 15.16 ±0.083 cm D)
Box (under surface)	6.410" H x <u>4.320"</u> W (front/rear of unit) x <u>14.750"</u> D without clamps (16.28 cm H x <u>10.97</u> cm W x 12.07 cm D without clamps) 6.410" H x <u>6.57"</u> W x 4.750" D with clamps (16.28 cm H x <u>16.68</u> cm W x 12.07 cm D with clamps)
Cable Cubby 300C	
Top plate (outer rim)	6.500" (16.51 cm) diameter circle
Surface cutout (inside rim).....	6.000 ±0.0325" (15.24 ±0.083 cm) diameter circle
Box (under surface)	6.410" H x <u>4.320"</u> W (front/rear of unit) x 4.750" D without clamps (16.28 cm H x <u>10.97</u> cm W x 12.07 cm D without clamps) 6.410" H x <u>6.57"</u> W x 4.750" D with clamps (16.28 cm H x <u>16.68</u> cm W x 12.07 cm D with clamps)
Cable Cubby 600	
Top plate (outer rim)	<u>6.960"</u> W x 6.960" D (<u>17.68</u> cm W x 17.68 cm D) Surface cutout (inside rim) <u>6.460 ±0.0325"</u> W x 6.460 ±0.0325" D (<u>16.41 ±0.083</u> cm W x 16.41 ±0.083 cm D)
Box (under surface)	6.410" H x <u>6.400"</u> W (front/rear of unit) x 4.750" D without clamps (<u>16.28</u> cm H x 16.26 cm W x 12.07 cm D without clamps) 6.410" H x <u>8.67"</u> W x 4.750" D with clamps (16.28 cm H x <u>22.02</u> cm W x 12.07 cm D with clamps)
Cable Cubby 800	
Top plate (outer rim)	<u>8.360"</u> W x 6.820" D (<u>21.23</u> cm W x 17.32 cm D)
Surface cutout (inside rim).....	<u>7.860 ±0.0325"</u> W x 6.320 ±0.0325" D (<u>19.96 ±0.083</u> cm W x 16.05 ±0.083 cm D)
Box (under surface)	6.410" H x <u>7.800"</u> W (front/rear of unit) x 4.750" D without clamps (16.28 cm H x <u>19.81</u> cm W x 12.07 cm D without clamps) 6.410" H x <u>10.07"</u> W x 4.750" D with clamps (16.28 cm H x <u>25.58</u> cm W x 12.07 cm D with clamps)
Cable AAP cable hole diameters	
Large cable hole	0.63" (1.60 cm)
Large grommet	0.45" (1.14 cm)
Medium cable hole	0.56" (1.42 cm)
Medium grommet.....	0.39" (0.99 cm)
Small cable hole	0.50" (1.27 cm)
Small grommet	0.31" (0.79 cm)
Product weight	
Cable Cubby 200	2.5 lbs (1.1 kg)
Cable Cubby 300S/300C.....	5.0 lbs (2.3 kg)
Cable Cubby 600	9.0 lbs (4.1 kg)
Cable Cubby 800	13.0 lbs (5.9 kg)
Shipping weight	
Cable Cubby 200	4 lbs (2 kg)
Cable Cubby 300S.....	8 lbs (4 kg)
Cable Cubby 300C	8 lbs (4 kg)
Cable Cubby 600	12 lbs (6 kg)
Cable Cubby 800	15 lbs (7 kg)
Vibration.....	ISTA 1A in carton (International Safe Transit Association)
Listings	UL, CUL
Compliances.....	CE
Warranty.....	3 years parts and labor

Model	Part Numbers
Square Bezel with 2 AAP openings	
Cable Cubby 200 US (black powder coat).....	60-716-0A
Cable Cubby 200 UK (black powder coat)	60-716-0B
Cable Cubby 200 ISRAEL (black powder coat)	60-716-0C
Cable Cubby 200 EU (black powder coat)	60-716-0D
Cable Cubby 200 FRANCE (black powder coat)	60-716-0E
Cable Cubby 200 AUS (black powder coat)	60-716-0F
Cable Cubby 200 INDIA (black powder coat).....	60-716-0G
Cable Cubby 200 SWISS (black powder coat)	60-716-0H
Circular Bezel with 3 AAP Openings (2 on international models)	
Cable Cubby 300C US (brushed black anodized)	60-527-01
Cable Cubby 300C US (brushed aluminum)	60-527-03
Cable Cubby 300C UK (brushed black anodized)	60-713-0B
Cable Cubby 300C UK (brushed aluminum)	60-713-1B
Cable Cubby 300C ISRAEL (brushed black anodized)	60-713-0C
Cable Cubby 300C ISRAEL (brushed aluminum).....	60-713-1C
Cable Cubby 300C EU (brushed black anodized)	60-713-0D
Cable Cubby 300C EU (brushed aluminum).....	60-713-1D
Cable Cubby 300C FRANCE (brushed black anodized).....	60-713-0E
Cable Cubby 300C FRANCE (brushed aluminum)	60-713-1E
Cable Cubby 300C AUS (brushed black anodized)	60-713-0F
Cable Cubby 300C AUS (brushed aluminum)	60-713-1F
Cable Cubby 300C INDIA (brushed black anodized)	60-713-0G
Cable Cubby 300C INDIA (brushed aluminum)	60-713-1G
Cable Cubby 300C SWISS (brushed black anodized)	60-713-0H
Cable Cubby 300C SWISS (brushed aluminum)	60-713-1H
Square Bezel with 3 AAP Openings (2 on international models)	
Cable Cubby 300S US (brushed black anodized).....	60-526-01
Cable Cubby 300S US (brushed aluminum)	60-526-03
Cable Cubby 300S UK (brushed black anodized)	60-712-0B
Cable Cubby 300S UK (brushed aluminum)	60-712-1B
Cable Cubby 300S ISRAEL (brushed black anodized)	60-712-0C
Cable Cubby 300S ISRAEL (brushed aluminum)	60-712-1C
Cable Cubby 300S EU (brushed black anodized).....	60-712-0D
Cable Cubby 300S EU (brushed aluminum)	60-712-1D
Cable Cubby 300S FRANCE (brushed black anodized)	60-712-0E
Cable Cubby 300S FRANCE (brushed aluminum).....	60-712-1E
Cable Cubby 300S AUS (brushed black anodized)	60-712-0F
Cable Cubby 300S AUS (brushed aluminum)	60-712-1F
Cable Cubby 300S INDIA (brushed black anodized).....	60-712-0G
Cable Cubby 300S INDIA (brushed aluminum)	60-712-1G
Cable Cubby 300S SWISS (brushed black anodized)	60-712-0H
Cable Cubby 300S SWISS (brushed aluminum)	60-712-1H
Square Bezel with 6 AAP Openings (5 on international models)	
Cable Cubby 600 US (brushed black anodized)	60-525-01
Cable Cubby 600 US (brushed aluminum)	60-525-03
Cable Cubby 600 UK (brushed black anodized)	60-714-0B
Cable Cubby 600 UK (brushed aluminum)	60-714-1B
Cable Cubby 600 ISRAEL (brushed black anodized)	60-714-0C
Cable Cubby 600 ISRAEL (brushed aluminum)	60-714-1C
Cable Cubby 600 EU (brushed black anodized)	60-714-0D
Cable Cubby 600 EU (brushed aluminum)	60-714-1D
Cable Cubby 600 FRANCE (brushed black anodized).....	60-714-0E
Cable Cubby 600 FRANCE (brushed aluminum).....	60-714-1E
Cable Cubby 600 AUS (brushed black anodized)	60-714-0F
Cable Cubby 600 AUS (brushed aluminum)	60-714-1F
Cable Cubby 600 INDIA (brushed black anodized)	60-714-0G
Cable Cubby 600 INDIA (brushed aluminum)	60-714-1G
Cable Cubby 600 SWISS (brushed black anodized)	60-714-0H
Cable Cubby 600 SWISS (brushed aluminum)	60-714-1H
Square Bezel with 8 AAP Openings (7 on international models)	
Cable Cubby 800 US (brushed black anodized)	60-524-01
Cable Cubby 800 US (brushed aluminum)	60-524-03
Cable Cubby 800 UK (brushed black anodized)	60-715-0B
Cable Cubby 800 UK (brushed aluminum)	60-715-1B
Cable Cubby 800 ISRAEL (brushed black anodized)	60-715-0C
Cable Cubby 800 ISRAEL (brushed aluminum)	60-715-1C
Cable Cubby 800 EU (brushed black anodized)	60-715-0D
Cable Cubby 800 EU (brushed aluminum)	60-715-1D
Cable Cubby 800 FRANCE (brushed black anodized).....	60-715-0E
Cable Cubby 800 FRANCE (brushed aluminum).....	60-715-1E
Cable Cubby 800 AUS (brushed black anodized)	60-715-0F
Cable Cubby 800 AUS (brushed aluminum)	60-715-1F
Cable Cubby 800 INDIA (brushed black anodized)	60-715-0G
Cable Cubby 800 INDIA (brushed aluminum)	60-715-1G
Cable Cubby 800 SWISS (brushed black anodized)	60-715-0H
Cable Cubby 800 SWISS (brushed aluminum)	60-715-1H

Specifications are subject to change without notice.

APPLICATION DIAGRAMS

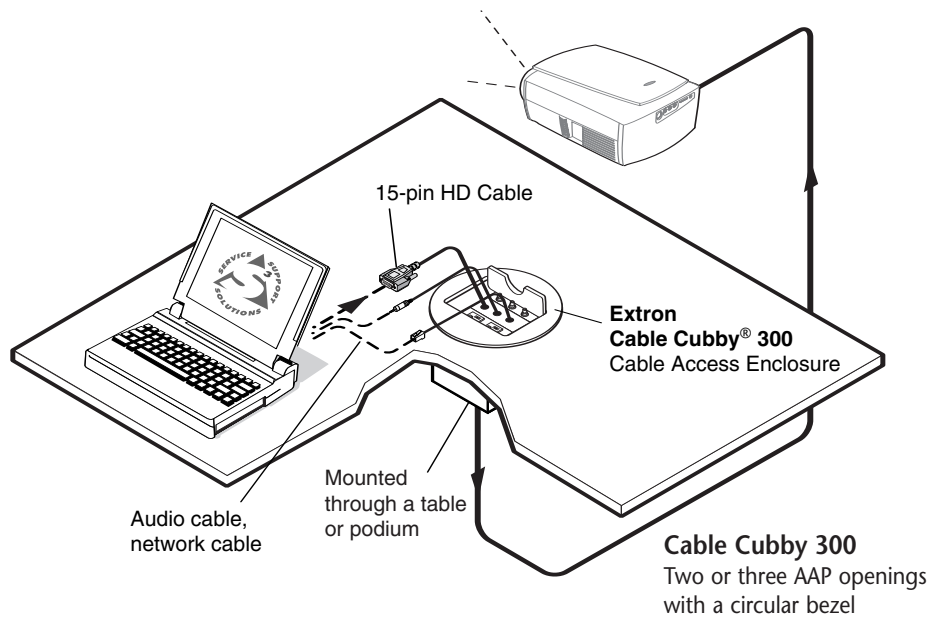
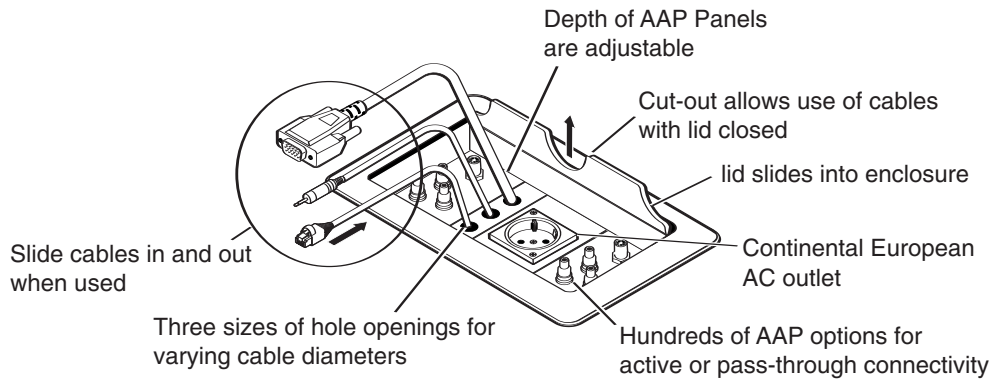

WORLD AC POWER CONNECTOR OPTIONS

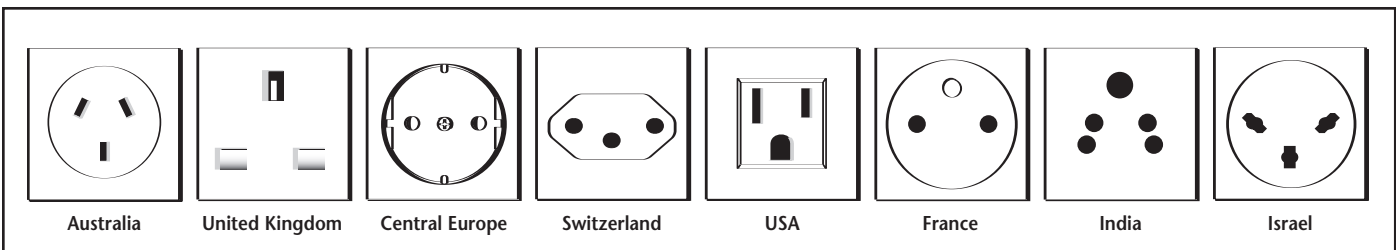

Extron Electronics, USA
1230 South Lewis Street
Anaheim, CA 92805
800.633.9876 714.491.1500
FAX 714.491.1517

Extron Electronics, Europe
Beeldschermweg 6C
3821 AH Amersfoort, The Netherlands
+800.3987.6673 +31.33.453.4040
FAX +31.33.453.4050

Extron Electronics, Asia
135 Joo Seng Rd. #04-01
PM Industrial Bldg., Singapore 368363
+800.7339.8766 +65.6383.4400
FAX +65.6383.4664

Extron Electronics, Japan
Daisan DMJ Bldg. 6F, 3-9-1 Kudan Minami
Chiyoda-ku, Tokyo 102-0074
Japan
+81.3.3511.7655 FAX +81.3.3511.7656